

© 2018 BY THE DUBE GROUP, INC.

THESE PLANS ARE COPYRIGHTED AND ARE SUBJECT TO COPYRIGHT PROTECTION AS AN "ARCHITECTURAL WORK" UNDER SECTION 102 OF THE COPYRIGHT ACT 17 U.S.C. AS AMENDED DECEMBER 1990 AND KNOWN AS THE ARCHITECTURAL WORKS COPYRIGHT PROTECTION ACT OF 1990. ANY USE OR REPRODUCTION OF THIS DRAWING IN WHOLE OR IN PART BY ANY MEANS WHATSOEVER IS STRICTLY PROHIBITED EXCEPT WITH THE SPECIFIC WRITTEN CONSENT OF THE ARCHITECT.

IN ACCORDANCE WITH NEVADA ADMINISTRATIVE CODE 623.780, DRAWINGS AND SPECIFICATIONS SHALL REMAIN THE PROPERTY OF THE ARCHITECT. COPIES OF THE DRAWINGS AND SPECIFICATIONS RETAINED BY THE CLIENT MAY BE UTILIZED ONLY FOR HIS USE AND FOR OCCUPANCY OF THE PROJECT FOR WHICH THEY WERE PREPARED, AND NOT FOR CONSTRUCTION OF ANY OTHER PROJECT. POSSESSION OF THESE DRAWINGS AND SPECIFICATIONS ON COMPUTER DISK OR OTHER ELECTRONIC MEANS IS STRICTLY PROHIBITED.

project title:
Gardnerville Station

**1395 US 395 N
GARDNERVILLE, NV**

job number: 16-100
date: June 30, 2017
drawn by: amm
checked by: prd
revisions:
▲ 1.11.18 PLN RW CMTS
▲ BIDDING 2.20.18
▲ BIDDING 2.26.18

sheet description:
NEW FLOOR PLAN

sheet number:

A200

GENERAL NOTES

- A. SEE GENERAL SHEETS FOR PROJECT NOTES, TYPICAL ACCESSIBILITY REQUIREMENTS AND TYPICAL SIGNAGE DETAILS
- B. BUILDING GRID LINES ARE SHOWN TO THE CENTERLINE OF EXISTING WALLS
- C. GENTLY CLEAN EXTERIOR OF BUILDING. PRESSURE WASH USING NO MORE THAN GARDEN HOSE PRESSURE AND A SIMPLE SOAP SOLUTION
- D. PREP SURFACES TO RECEIVE NEW PAINT PER SPECIFICATIONS. SEAL ALL HOLES, CRACKS AND PENETRATIONS WITH METAL, WOOD, CONCRETE, OR MASONRY BONDING FILLER AS REQUIRED FOR SUBSTRATE AND AS RECOMMENDED BY MANUFACTURER OF EACH PRODUCT. ALL WORK TO CONFORM TO CURRENT OSHA AND EPA STANDARDS FOR LEAD PAINT REMOVAL

KEY NOTES:

- 1 INSTALL (N) 65" LED FLAT SCREEN INTERACTIVE TOUCH SCREEN DISPLAY. CONTRACTOR TO ADEQUATE BACKING, SEE DETAIL 1/A800
- 2 INSTALL (N) 4" ROUND STEEL COLUMN (TYPICAL OF 7). SEE STRUCTURAL DRAWINGS FOR MORE INFORMATION
- 3 INSTALL (N) BABY CHANGING STATION. PROVIDE BACKING TYPICAL.
- 4 INSTALL (N) FURRED OUT WALL AROUND EXTERIOR OF (E) BUILDING. INSTALL (N) STORM WINDOWS W/(N) ALUMINUM SILLS (SEE WINDOW SCHEDULE). WALL TO BE CONSTRUCTED OF 3 5/8" STUDS AND SPRAY FOAM INSULATION FILLED CAVITIES. SEE WALL FINISH SCHEDULE FOR MORE INFORMATION.
- 5 INSTALL (N) COUNTER TOP W/ SINK. SEE MECHANICAL DRAWINGS FOR MORE INFORMATION.
- 6 INSTALL (N) PLUMBING FIXTURE. SEE PLUMBING DRAWINGS FOR MORE INFORMATION.
- 7 SERVICE AND REPAIR EXISTING ALUMINUM MULTI-LIGHT OVERHEAD SECTIONAL GARAGE DOORS, INCLUDING TRACKS. REMOVE WINDOW FILM (TINT), PAINT, DIRT AND STREAKS FROM FRAMES AND GLAZING USING GENTLE CLEANING METHODS. REMOVE AND REPLACE CAULK, SEALANT AND PUTTY FORM INTERIOR AND EXTERIOR FACES WITH IN-KIND MATERIALS. VERIFY OPERATION OF DOOR / TRACK / LOCK ASSEMBLY AND REPAIR AS NECESSARY TO ENSURE OPERATION. REPLACE PLEXIGLAS PANES WITH CLEAR TEMPERED GLASS IN-KIND
- 8 FLOAT (N) CONCRETE SLAB (ROUGHLY 2") IN UTILITY ROOM 102. TRANSITION WILL BE SEAMLESS FROM STORAGE ROOM 102 TO MEETING ROOM 101
- 9 INSTALL (N) WOOD WALL PANEL SYSTEM, SEE FINISH SCHEDULE
- 10 INSTALL (N) PLUMBING WALL. WALL TO BE CONSTRUCTED OF TILE FINISH O/ 1/4" HARDI BACKER BOARD O/ 8" METAL STUD
- 11 FUTURE 4' X 8' SPACES FOR MURALS
- 12 CONTRACTOR TO INSTALL 75" FLAT SCREEN. PROVIDE ADEQUATE BACKER. SEE DETAIL 1/A800
- 13 CONTRACTOR TO INSTALL (N) PLUMBING CHASE WALL. SEE WALL LEGEND FOR MORE INFORMATION
- 14 N.I.C. OWNER SUPPLIED VINTAGE GAS PUMP
- 15 INSTALL MAX OCCUPANCY SIGN PER I.B.C. 1004.3 TO COVER (E) WINDOW
- 16 REFER TO SHEET E201 FOR FLUSH BOXES (TYP. OF 2)
- 17 FUTURE 6'-0" X 4'-0" SPACE FOR MURAL
- 18 CONTRACTOR TO INSTALL (N) SPECKLED VINYL EPOXY FLOORING. SEE FINISH SCHEDULE
- 19 REVERSE DOOR SWING. PLUG (E) HOLES TO MATCH ADJACENT
- 20 CONTRACTOR TO REMOVE (E) DOORS AND PREP FOR (N) DOORS
- 21 CONTRACTOR TO PROVIDE 2'-6" X 1'-6" SHELF FOR EQUIPMENT, MOUNT AT 7'-0" A.F.F.
PROVIDE (N) 3/4" WTR SERVICE IP POLYETHYLENE TUBING CLASS 200 FROM OUTSIDE BUILDING THROUGH (N) INSULATED FURRED OUT WALL TO ABOVE (N) BEAM STRUCTURE, SEE REFLECTED CEILING PLAN AND CIVIL PLANS FOR MORE INFORMATION
- 22

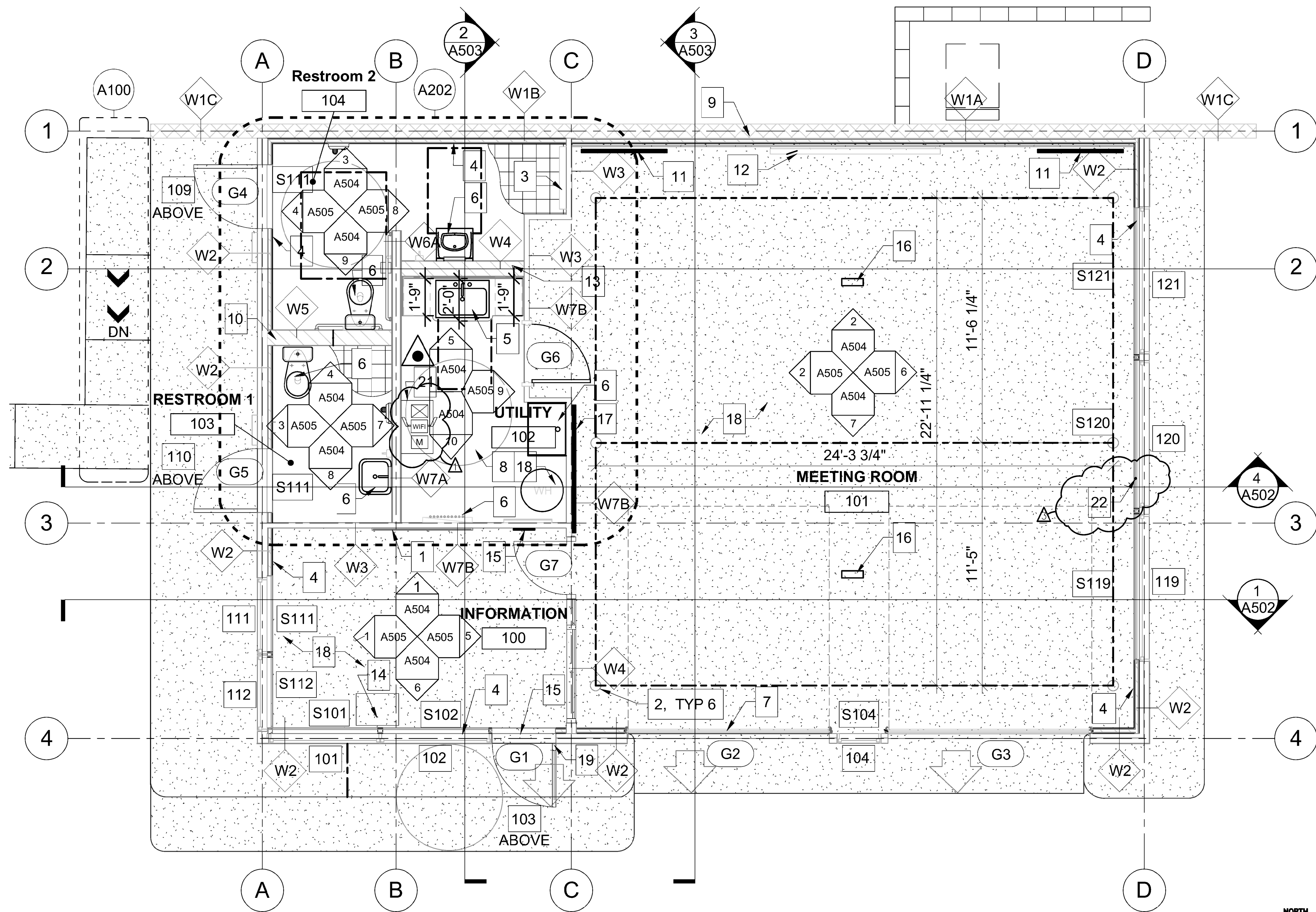

NEW FLOOR PLAN
3/8" = 1'-0"

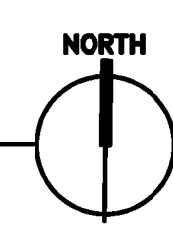

LEGEND
▲ FIRE EXTINGUISHER LOCATIONS

NOTE: FULL SETS ARE 24"X36" HALF SIZE SETS ARE 12"X18" CONFIRM SCALES SHOWN ON DRAWINGS